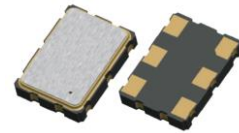

Features

- Typical 2.05 x 1.65 x 0.75 mm ceramic SMD package.
- low Power Supply Voltage: 3.3V, 2.5V, 1.8V
- Conforms to AEC-Q200
- Tight symmetry (45 to 55%) available
- Tri-state enable/disable

Typical Application

- WLAN/WiMax
- Mobile Phone
- - DSC, Set-top Box, HDTV

BS2016A Series

Parameter	3.3v		2.5V		1.8V		Unit	Conditions	
	Min.	Max.	Min.	Max.	Min.	Max.			
Supply Voltage Variation	VDD-10%	VDD+10%	VDD-5%	VDD+5%	VDD-5%	VDD+5%	V		
Frequency Range	1.5	50	1.5	50	1.5	50			
Standard Frequency	24, 26						MHz	Standard frequencies are frequencies which the crystal has been designed and does not imply a stock position	
Transition Time Rise Time / Fall Time	1.5 MHz \leq Fo < 20 MHz	-	15.0	-	10	-	7	nSec	Transition times are measured between 10% and 90% of VDD, with an output load of 15 Pf.
	20 MHz \leq Fo < 50 MHz	-	3	-	3	-	4		
Supply Current (No Load)	-	15	-	10	-	7	uA	@No Load	
Duty Cycle	45	55	45	55	45	55	%		
Output Level	Output High	2.97	-	2.25	-	1.62	-	V	
	Output Low	-	0.33	-	0.25	-	0.18	V	
Tri-State Mode (Input to Pin 1)	Enable	2.31	-	1.75	-	1.26	-	V	
	Disable	-	0.99	-	0.75	-	0.54		
Stand by Current	-	10	-	10	-	10	uA		
Period Jitter (pk-pk)	-	40	-	40	-	40	pSec		
RMS Phase Jitter (Integrated 12 kHz~20 MHz)	-	1	-	1	-	1	pSec		
Start Time	-	2	-	2	-	2	mSec		
Aging	-	± 3	-	± 3	-	± 3	ppm	@ 25°C, First Year	
Storage Temp. Range	-55	125	-55	125	-55	125	°C		
FREQ. STABILITY vs. TEMP. RANGE		± 20 ppm		± 25 ppm		± 50 ppm			
	-10~+60	Available		Available		Available			
	-20~+70	Conditional		Available		Available			
	-40~+85	Conditional		Available		Available			
	-40~+125	Not Available		Not Available		Conditional			

Note: not all combination of options are available. Other specifications may be available upon request.

Reliability

Parameter	Condition
Temperature Stress Test	IEC60068, GJB360B
Mechanical Stress Test	IEC60068, GJB360B
EMC Test (ESD)	IEC61000, JESD22
Solderability	EIA/JESD22-B102-C
Contact Pads	Gold over Nickel
RoHS	RoHS Directive 2011/65/EU Annex II Recasting 2002/95/EC

Outline Dimension & Pin Connections

Unit: mm

[TOP VIEW]

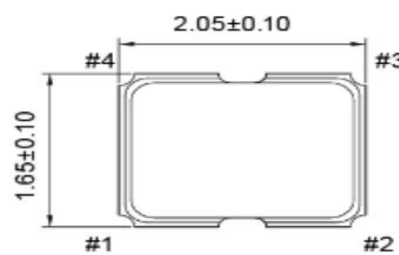

[BOTTOM VIEW]

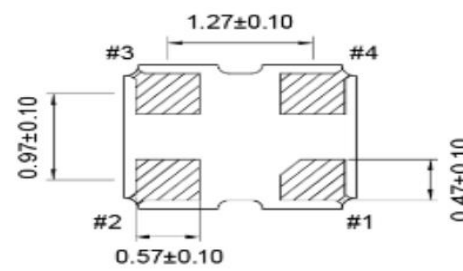

[SIDE VIEW]

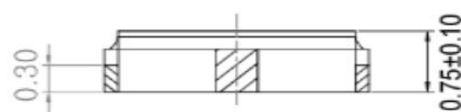

PIN#	FUNCTION
1	Tri-State
2	GND
3	Output
4	V _{DD}

Ordering Guide

BS2016A X X X XXX X XXX.XX X

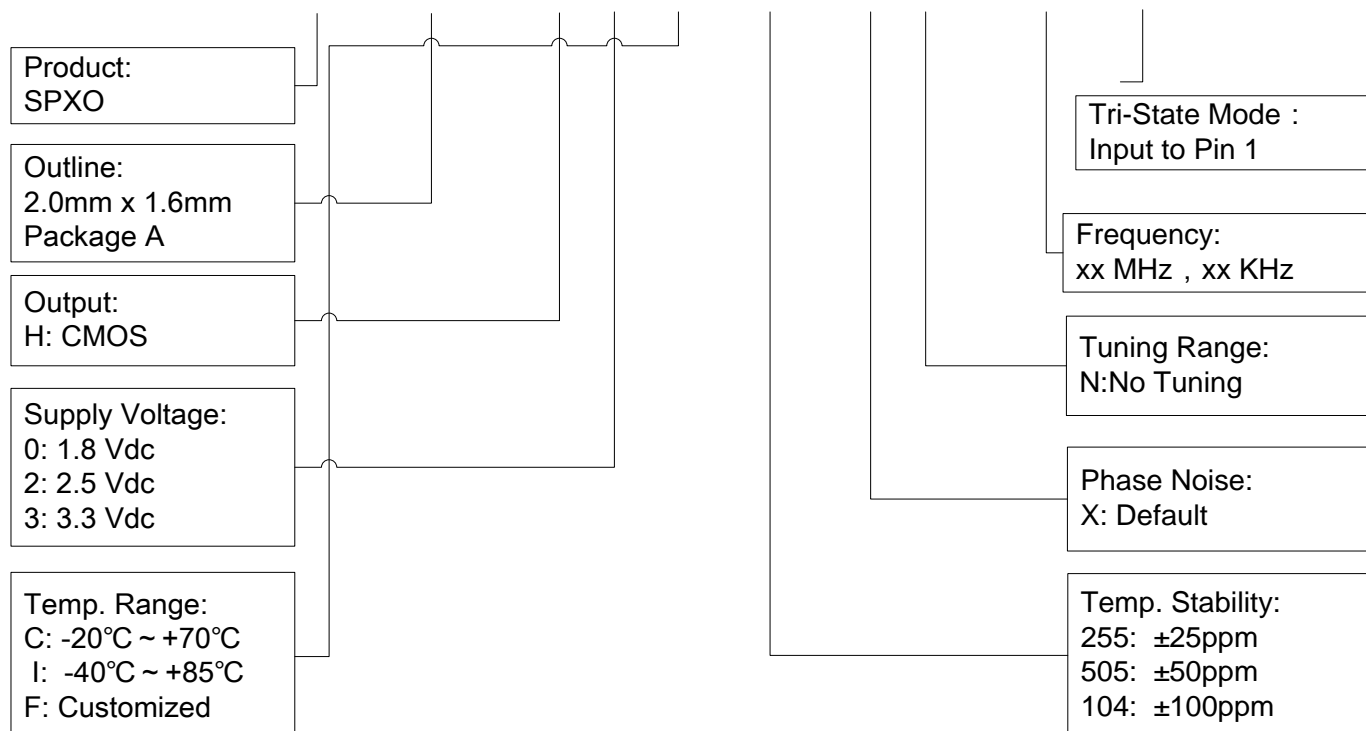

Example: BS2016AD3I505CN20

Disclaimer

Xtaltq Technologies Co., Limited reserves the right to make changes to the product(s) and/or information contained herein without notice. No liability is assumed as a result of their use or application. No rights under any patent accompany the sale of any such product(s) or information.